

Five Channels Dam



Five Channels Dam



River Hydro Asset Key Terms

Definitions/purpose of the major components and aspects critical of safe, compliant, and reliable operations:

- **Dam:** The entire barrier to hold back the water (reservoir) typically consists of embankments, spillways, and powerhouse
- **Spillway:** Primary location for water flow when not used for generation
- **Powerhouse:** Location of generation units
- **Embankment:** Earthen barrier to hold back the reservoir, which contains a hydraulic barrier (core wall)



Five Channels Dam Structures



23

T29 F
Five Channels Dam

Approximate
Five Channels
Dam Location

S 41° 0' W 125' to Flower House
N 87° 45' W 32.5'
N 42° 30' W 135'
N 17° 30' W 197.5'

FIVE CHANNELS ON
DAM SITE #4

Orig
for I

PSC

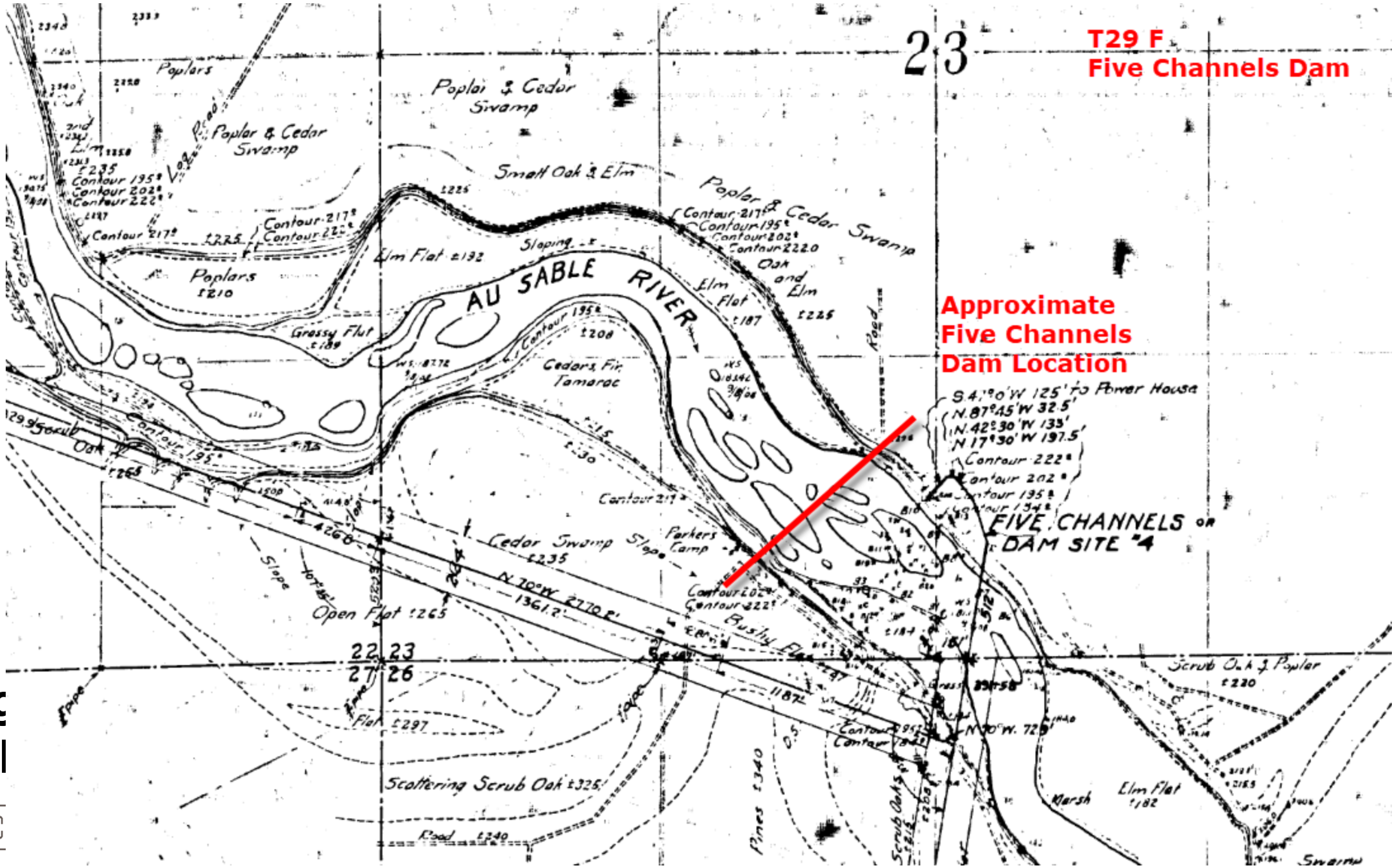

Five Channels Hydro

- With a capacity of 6,000 kilowatts, construction was completed in 1912.
- The site of the workers' camp built to support construction of the dam was listed on the National Register of Historic Places.
- It holds up as an American example of incorporating worker safety and health provisions into construction site living, drawing heavily on lessons learned in the building of the Panama Canal.



General Information: Five Channels Dam

FERC License Expiration Date: June 30, 2034

Dam Height (ft.): 40

Length of Dam (ft.): 800

Drainage Area (sq. miles): 1,613

Impoundment Area (acres): 237

Age (years): 110

FERC Hazard Classification: High*

Approximate Population at Risk: 474

Approximate Recreation Use:

- 2,700 visitors annually
- 13 boat docks

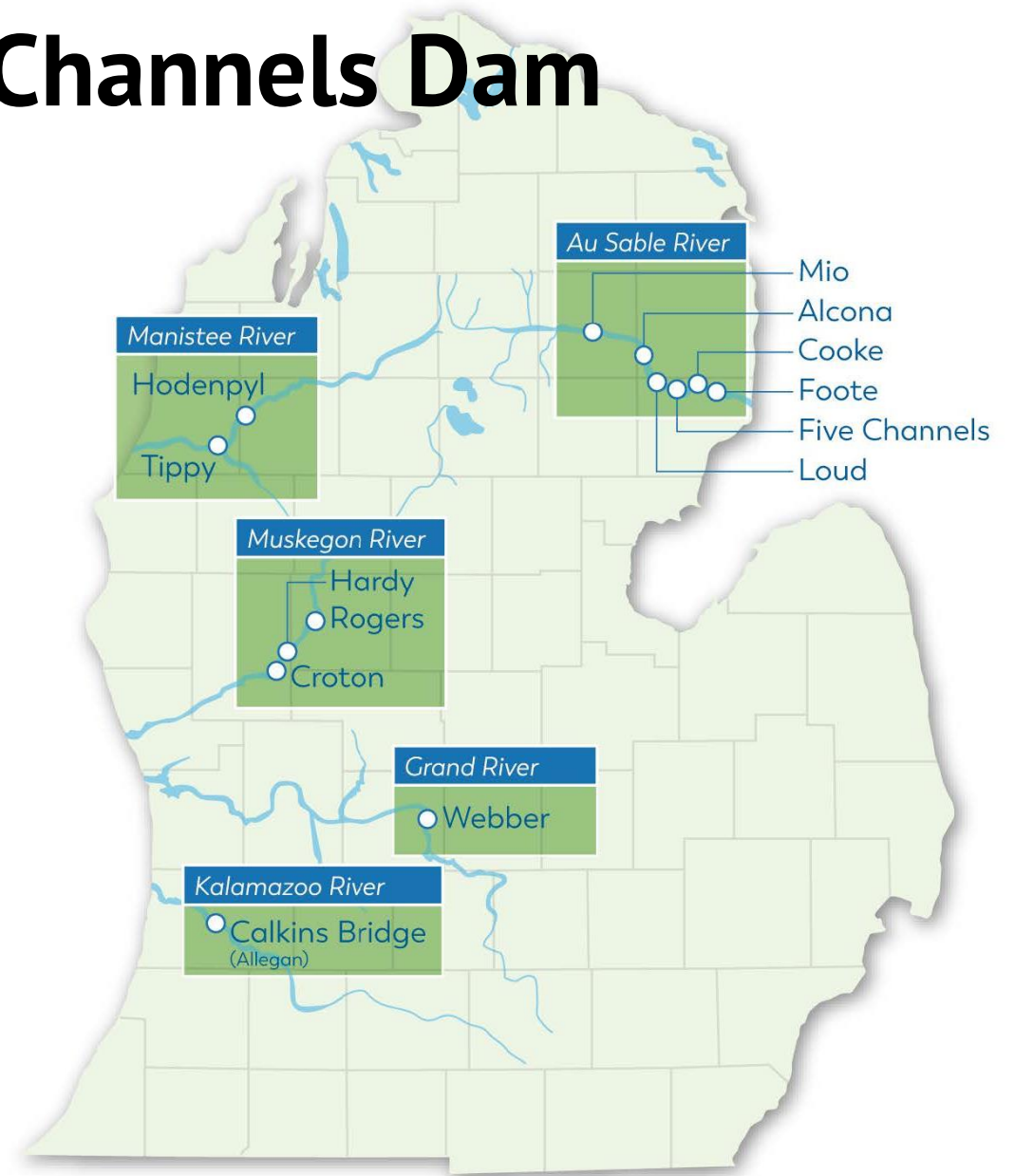

**FERC assigns “high” to structures where failure or misoperation will probably result in loss of human life.*

Percentage of Fuel Type Used to Produce Consumers Energy's Total Electricity

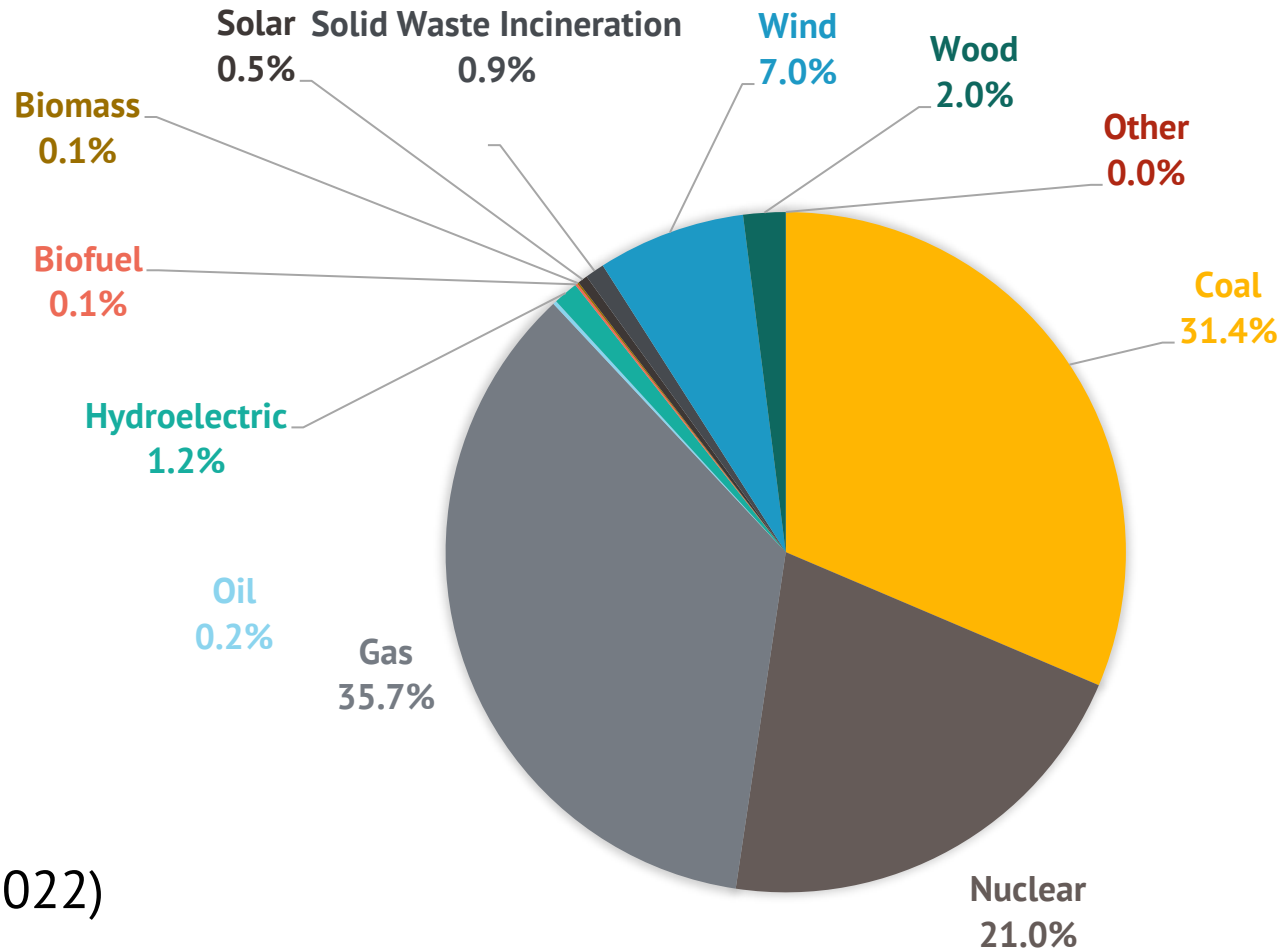

(Apr 2021-Mar 2022)