

REV	DATE	DESCRIPTION
D	08/02/23	ISSUED FOR INFORMATION
C	05/02/23	UPDATED AREA BOUNDARY, REISSUED FOR CLIENT REVIEW
B	27/AN/23	ISSUED FOR INFORMATION
A	01/AN/23	ISSUED FOR CLIENT REVIEW

CLIENT	Consumers Energy
PROJECT LOCATION	Ogemaw, Michigan
SYSTEM RATING (MW)	185.1
DC/AC RATIO	1.30
MODULE MANUFACTURER	JHS
MODULE RATING (W)	388.416
MODULE COUNT	26
STRING COUNT	13,016
INVERTER MANUFACTURER	NextTracker
INVERTER NAMEPLATE (kW)	34.5
TOTAL INVERTER NAMEPLATE (kW)	4,600
AC TRANSFORMER RATING (kVA @ 50%)	4,000
AC SYSTEM VOLTAGE (V)	34.5
PACKING MANUFACTURER	SAT
TYPE OF JOINTION	100
ADJ. W/TH	0.256
PITCH (FEET)	21.0
33 STRING RACKS	3,862
33 STRING RACKS	1,105

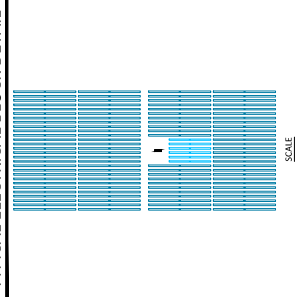

- ### NOTES
- THE SITE LAYOUT WAS DEVELOPED BASED ON CEC PROVIDED WAZ FILE.
 - WETLAND AREAS SHOWN ON THIS DRAWING ARE APPROXIMATE AND BASED ON AERIAL IMAGERY AND NATIONAL WETLAND INVENTORY DATABASE.
 - THE FOLLOWING SETBACKS WERE CONSIDERED WHEN DETERMINING USABLE AREA FOR SOLAR DEVELOPMENT:
 - BUILDING FOOTPRINT: 100 FEET
 - ROAD RIGHT-OF-WAY: 100 FEET
 - TREE LINE: 100 FEET
 - WETLANDS/FLOOD PLAIN: 50 FEET
 - EXISTING WATER WELLS: 25 FEET
 - EXISTING TRANSMISSION: 50 FEET
 - EXISTING OH & GAS WELLS: 250 FOOT X 250 FOOT BUFFER
 - EXISTING OH & GAS ACCESS ROADS: 50 FEET
 - GRADING & GUY WIRE: 100 FEET
 - ALL EXISTING WELLS, POWER PIPES AND GAS LINES ARE SHOWN. PROJECT BOUNDARY HAVE BEEN FLAGGED IN RED AND UNDERGROUND UTILITIES ARE UNDISCOVERED.

LEGEND

- PROPERTY LINE
- FENCE LINE
- USABLE AREA
- BOUNDARY
- ARRAY BOUNDARY
- INVERTER SKID
- TREE LINE
- EXISTING TRANSMISSION LINES
- EXISTING TRANSMISSION
- EXISTING ROADS
- CENTERLINE
- NON-BUILDABLE AREA
- COLLECTOR
- PANEL AREA
- AC COT 110X
- AC COT 120X
- AC COT 210X
- AC COT 220X
- AC COT 310X
- AC COT 320X

PROPOSED SITE ENTRANCE

EXISTING WETLANDS WITH 50 FT SETBACK

PROPOSED PV MODULES (3 STRING BACK)

PROPOSED PV MODULES (2 STRING BACK)

SCALES > 15%

EXISTING GAS WELLS

SECTIONALIZING CABINET

BORE LOCATION

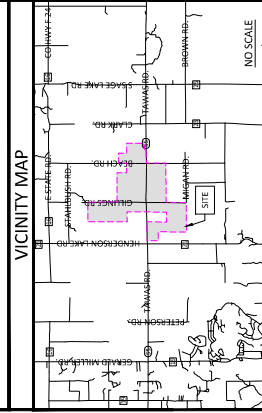

NOT TO BE USED FOR CONSTRUCTION

SCALE: 1"=700'

CONTRACT NO. 401959-DS-1400

BLACK & VEATCH

Consumers Energy

LOGAN SOLAR
LOGAN TOWNSHIP, MICHIGAN

PRELIMINARY SITE LAYOUT

DATE: 10/22/23

SCALE: 1"=700'

JOB: 401959-DS-1400

SHEET: 1 OF 1

UNIT: D